

CASE HARDENED AND GROUND SHAFTS

DIAMETER	MATERIAL
1/4" TO 2"	C1060 STEEL HARDENED C60-65 OR 440 STAINLESS STEEL HARDENED C50-55

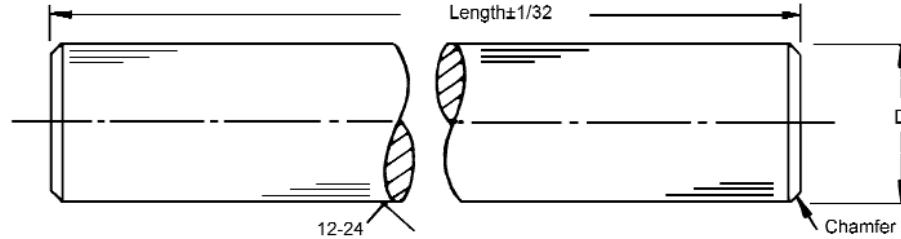

C1060 STEEL STOCK NO. (36" long)	C1060 STEEL STOCK NO. (12" long)	440 STAINLESS STEEL STOCK NO. (36" long)	NOM. DIA.	D DIAMETER	MAX. LENGTH AVAILABLE TO ORDER
LMS-4-36	-	-	1/4	.2490-.0005	8 ft.
LMS-5-36	-	-		.2495-.0005	
LMS-6-36	-	-	3/8	.3740-.0005	11 ft.
LMS-7-36	-	-		.3745-.0005	
LMS-46-36	LMS-46-12	-		.3750-.0005	
LMS-8-36	-	LMT-8-36	1/2	.4990-.0005	11 ft.
LMS-9-36	-	LMT-9-36		.4995-.0005	
LMS-48-36	LMS-48-12	-		.5000-.0005	
LMS-50-36	LMS-50-12	-	5/8	.6250-.0005	11 ft.
LMS-12-36	-	LMT-12-36	3/4	.7490-.0005	11 ft.
LMS-13-36	-	LMT-13-36		.7495-.0005	
LMS-52-36	LMS-52-12	-		.7500-.0005	
LMS-16-36	-	LMT-16-36	1	.9990-.0005	12 ft.
LMS-17-36	-	LMT-17-36		.9995-.0005	
LMS-56-36	LMS-56-12	-		1.0000-.0005	
LMS-20-36	-	-	1 1/4	1.2490-.0005	11 ft.
LMS-21-36	-	-		1.2495-.0005	
LMS-60-36	LMS-60-12	-		1.2500-.0005	
LMS-24-36	-	-	1 1/2	1.4989-.0005	11 ft.
LMS-25-36	-	-		1.4994-.0005	
LMS-64-36	LMS-64-12	-		1.5000-.0005	
LMS-32-36	-	-	2	1.9987-.0005	11 ft.
LMS-33-36	-	-		1.9994-.0007	
LMS-72-36	LMS-72-12	-		2.0000-.0005	

Straightness

LMS-4, LMS-5 best efforts basis

LMS-6 to LMS-72 within .001"-.002"/FT.

Note: Shafting available in other lengths. Specify by similar stock number and length required.

Example: LMS-21-56" (1.2495 Diameter 56" Long)