

# Flex-E-Gear Technical Data

**Operating Notes:** Due to the unique design of molded polyurethane over a Stainless Steel cable, the gear drive chains offer a strong, flexible, quiet, lube-free drive system that can obtain zero backlash.

A  
8

## 32GCF Series

- 32 Pitch
- .0982 Circular Pitch  
Cable Chain & Sprockets

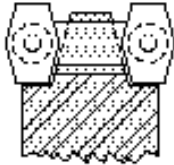

- Cable Diameter .018" Stainless Steel
- Ultimate Tensile 30 lbs., 4 lb / pin
- Recommended Maximum Operating Speed 376 ft./min.
- Recommended Operating Load 6 - 7 lbs
- Minimum Recommended Sprocket Diameter 1/2" PD
- Weight .13 oz/ft

## 31GCF Series

- 1/10 Pitch
- .1000 Circular Pitch  
Cable Chain & Sprockets

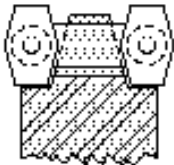

- Cable Diameter .018" Stainless Steel
- Ultimate Tensile 30 lbs., 4 lb / pin
- Recommended Maximum Operating Speed 376 ft./min.
- Recommended Operating Load 6 - 7 lbs
- Minimum Recommended Sprocket Diameter 3/4" PD
- Weight .13 oz/ft

## 24GCF Series

- 24 Pitch
- .1309 Circular Pitch  
Cable Chain & Sprockets

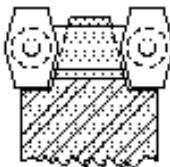

- Cable Diameter 1/32" Stainless Steel
- Ultimate Tensile 100 lbs., 10 lb / pin
- Recommended Maximum Operating Speed 376 ft./min.
- Recommended Operating Load 20-25 lbs
- Minimum Recommended Sprocket Diameter 1/2" PD
- Weight .14 oz/ft

## 16GCF Series

- 16 Pitch
- .1964 Circular Pitch  
Cable Chain & Sprockets

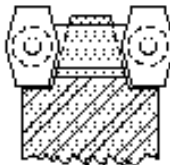

- Cable Diameter 3/64" Stainless Steel
- Ultimate Tensile 200 lbs., 23 lb / pin
- Recommended Maximum Operating Speed 376 ft./min.
- Recommended Operating Load 40-50 lbs
- Minimum Recommended Sprocket Diameter 1 3/8"
- Weight .14 oz/ft